

Vibratory Tube Conveyors

type 150 / 200 / 250 / 300 / 350 / 400 / 550



- Conveying and dosing of bulk goods (cereals, granules, powders, flours, etc.)
- Closed and dust-proof design for hygienic und clean conveyance
- Length up to 8.000 mm (depending on type)
- Solid steel construction

Standard Construction

- Setup supported or suspended with slope angle up to 35°
- Elastic supports
- Inlet and outlet with flexible connections
- Driven by two vibrators, mounted below / beside / above the conveying tube
- Removable inspection cover in the outlet area

Options

- Frequency converter for continuous adjustment of motor rpm
- Additional inlets
- Execution in stainless steel (suitable for food, fertilizer)
- Flexible connections and sealings in food approved quality
- Quick fastener for inspection cover
- Wear protection lining

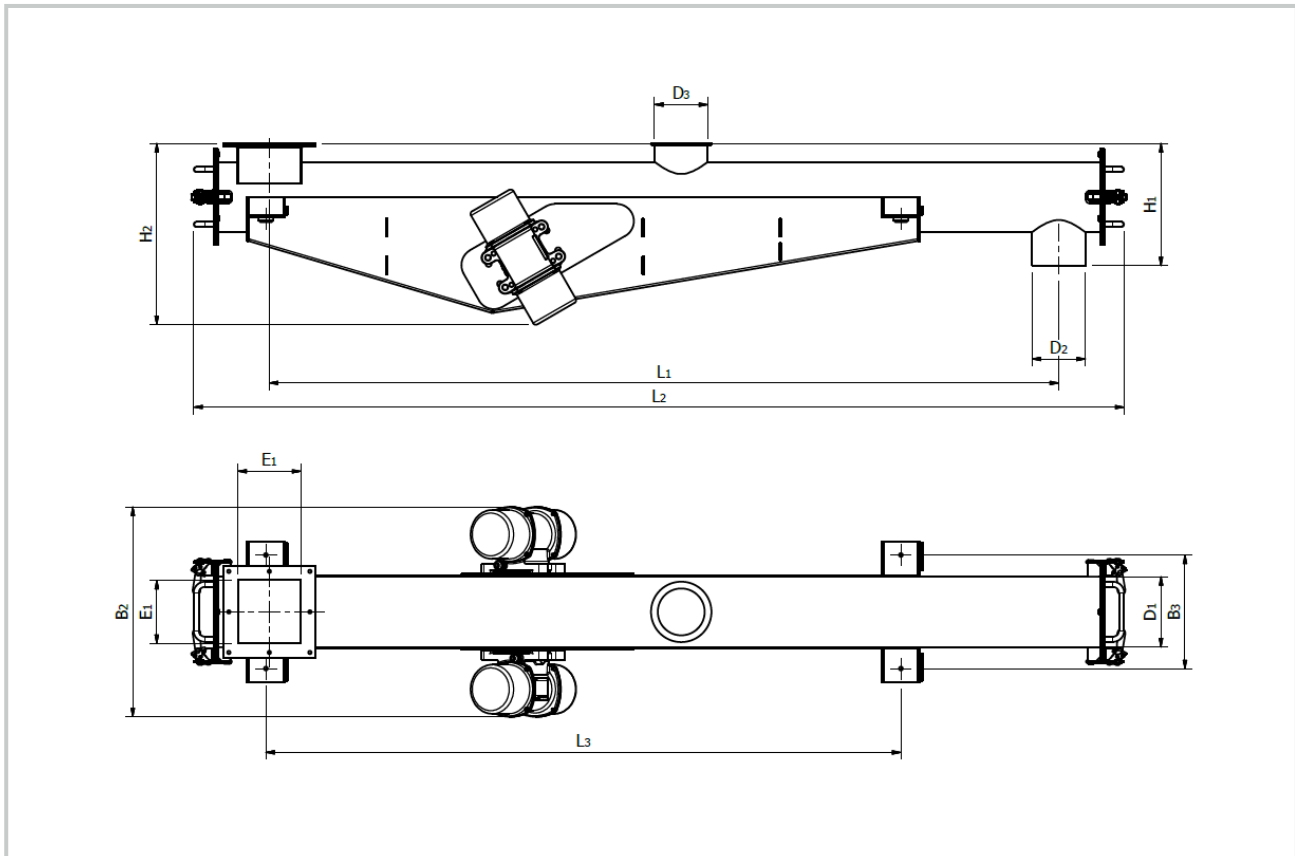

Type		150	200	250	300	350	400	550
Vibrators	kW	2x 0,3	2x 0,3	2x 0,525	2x 0,525	2x 0,55	2x 0,55	2x 1,1
Capacity (max)	m ³ /h	5,0	10,0	15,0	22,0	30,0	45	80
D1	mm	149	199	249	299	349	398	558
D2	mm	149	199	249	299	349	398	558
D3	mm	119	149	149	199	199	199	199
E1	mm	134	184	234	284	334	383	543
L1 (min / max)	mm	1000 / 8000	1000 / 8000	1250 / 8000	1250 / 8000	1500 / 8000	1500 / 8000	2000 / 8000
L2	mm	L1 + 425	L1 + 425	L1 + 480	L1 + 575	L1 + 625	L1 + 700	L1 + 860
L3	mm	1850	1850	1850	1850	1850	1850	1850
B2	mm	561	611	700	745	805	850	1100
B3	mm	280	330	380	450	551	565	725
H1	mm	276	330	380	455	525	585	1020
H2	mm	500	530	565	650	710	730	755
Weight (L1 = 2.500 mm)	kg	130	145	175	200	250	270	340

- Support / Suspension not included
- D1 / D2 / D3: internal diameter
- Other diameters for lower / higher capacity on request