

De-Awner type Vertigran VD 30 / 60 / 100



- Separation of awns and husks from grain and grass seeds
- Polishing of grain and grass seeds
- Automatic outlet flap shortens or extends the processing time, depending on whether an intense or light de-awning is necessary

Standard Construction

- Solid steel construction
- Mantle with replaceable wear plates
- Large inspection hatches
- Adjustable discharge flap
- Continuously adjustable to various capacities
- V-belt drive and motor
- Control system for automatic capacity regulation (control box or components for existing control unit incl. module SPS-Simatic s7)

Type		VD 30	VD 60	VD 100
Motor	kW	18,5	30	45
Capacity (Barley)	t/h	30	50	80

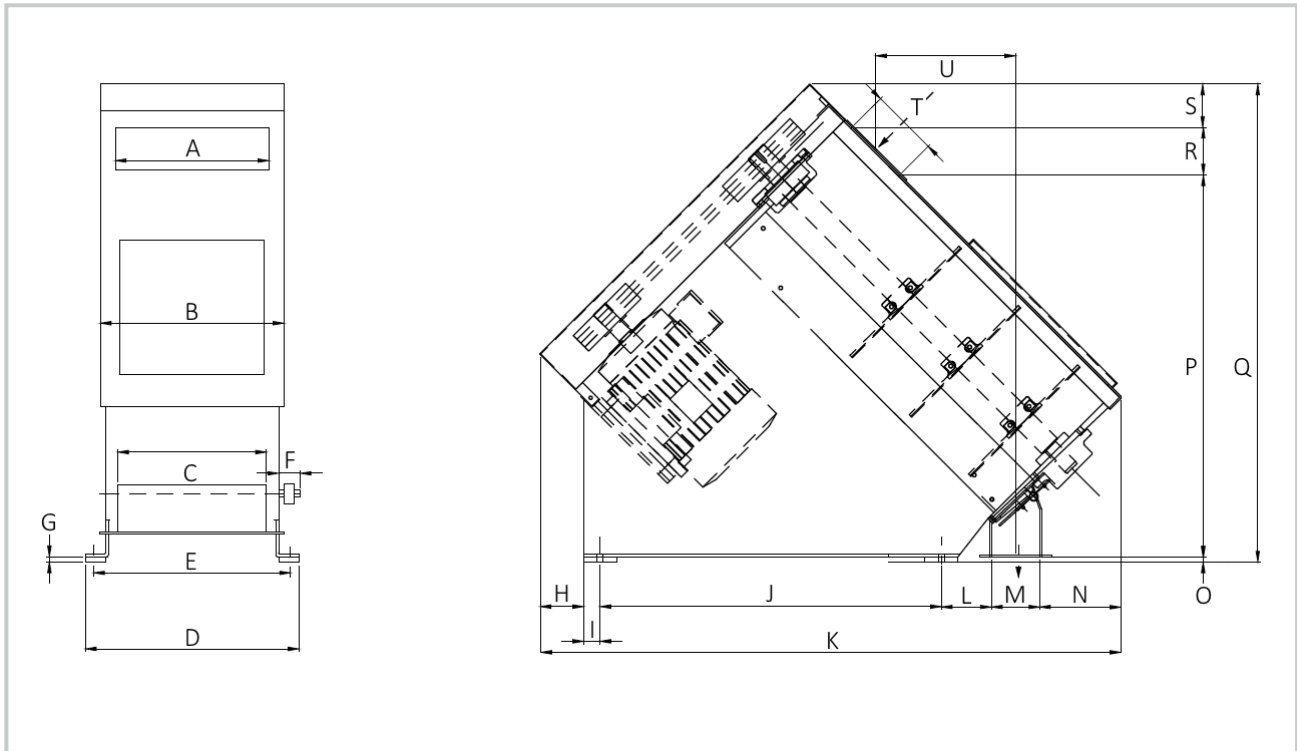

		A	B	C	D	E	F	G	H	I	J
VD 30	mm	430	530	490	635	575	80	20	120	60	800
VD 60	mm	570	680	550	790	730	80	20	125	60	875
VD 100	mm	570	680	550	790	730	80	20	140	60	1265

	K	L	M	N	O	P	Q	R	S	T	U
VD 30	1610	255	180	200	88	950	1325	130	150	180	313
VD 60	1730	885	180	300	10	1095	1390	140	145	200	235
VD 100	2135	185	180	300	18	1412	1770	175	160	250	565